



FAG

**2203-2RS-TVH**

Self-aligning ball bearing

Schaeffler ID:  
0167026620000Self-aligning ball bearing 22..-2RS-TVH,  
seals, plastic cage

## Technical information

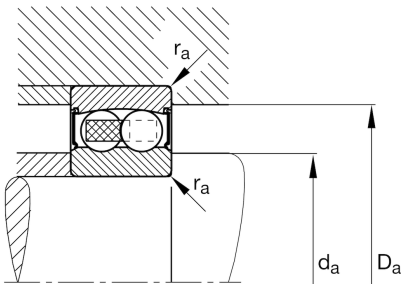
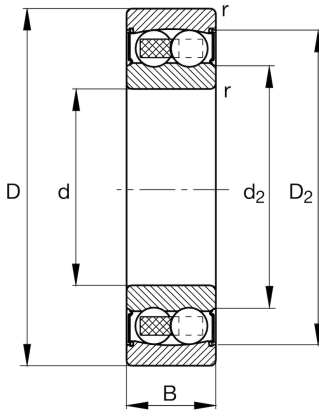
**Main Dimensions & Performance Data**

d	17 mm	Bore diameter
D	40 mm	Outside diameter
B	16 mm	Width
$r_{min}$	0,6 mm	Minimum chamfer dimension
$C_r$	8.100 N	Basic dynamic load rating, radial
$C_{0r}$	2.010 N	Basic static load rating, radial
$C_{ur}$	128 N	Fatigue load limit, radial
$n_G$	11.300 1/min	Limiting speed
	0,095 kg	Weight

**Dimensions**

$D_2$	34,3 mm	Caliber diameter outer ring
$d_2$	21,6 mm	Caliber diameter inner ring

**Mounting dimensions**

$d_{a min}$	21,2 mm	Minimum diameter shaft shoulder
$D_{a max}$	35,8 mm	Maximum diameter of housing shoulder
$r_{a max}$	0,6 mm	Maximum fillet radius

**Calculation factors**

e	0,33	Limiting value of $F_a/F_r$ for the applicability of diff. Values of factors X and Y
$Y_1$	1,93	Dynamic axial load factor
$Y_2$	2,98	Dynamic axial load factor
$Y_0$	2,02	Static axial load factor

**Temperature range**

$T_{min}$	-20 °C	Operating temperature min.
$T_{max}$	100 °C	Operating temperature max.